

## Modern Design – versatile, easy to install and equipped with tailor-made accessories

The WOLFA gutters with a nominal width of 95 mm are available in three different heights and shapes. Depending on the gutter type and grating, the gutters can be used in many different ways and for loads of up to class D 400. Simple and compact plug-in connection by means of a safety seam. One catch basin for all three sizes. All gratings are screwed.

### Flat gutter 100/6V

Load class A 15 - C 250



- Installation height: 60 mm
- Width: 135 mm, inner width: 95 mm
- Drain spout: NW 100

Sizes in mm

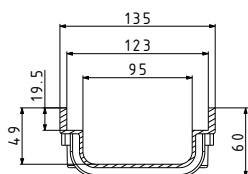

### Drainage gutter 100/8V

Load class A 15 - C 250



- Installation height: 100 mm
- Width: 135 mm, inner width: 95 mm
- Drain spout: NW 100

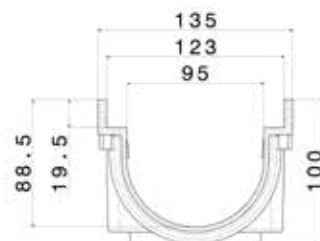

### Drainage gutter 100V line

Load class A 15 - D 400



- Installation height: 149 mm
- Width: 135 mm, inner width: 95 mm
- Drain spout: NW 100

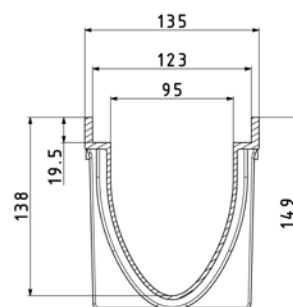

Colors:



light gray



charcoal gray

For further technical data see page 21

### Accessories 100/6V and 100/8V

- Metal strips for gutter fastening on the unfinished floor
- Gutter end guard
- Drain connection kit NW100 with intake filter odor stop and two lateral end guards.
- Adapter for catch basin
- Catch basin
- Drain connection ring 100 NW 50 with lateral outlet
- Variable elbow piece for corner, T or cross connection
- Gutter elevation



Variable elbow piece  
100/6V



Drain connection kit  
for all types



Catch basin (with adapter) for  
all types



Lateral outlet  
connection NW 100  
for 100V line

### Accessories 100V line

- Gutter end guard
- Drain connection kit NW100 with intake filter odor stop and two lateral end guards.
- Lateral NW 100 drain connection
- Drain connection ring 100 NW 50 with lateral outlet
- Variable elbow piece for corner, T or cross connection
- Catch basin 100V line